



# Leading for Transformation

**JUNE 12-13, 2019**

The Riley Center  
2200 5th St. | Meridian, MS



MISSISSIPPI  
DEPARTMENT OF  
EDUCATION

Ensuring a bright future for every child



MISSISSIPPI STATE UNIVERSITY™  
RESEARCH & CURRICULUM UNIT

## June 12 | Plenary Session

### DR. CARLA J. EVERS



**Dr. Carla J. Evers** is the superintendent of education for Pass Christian School District. She previously served as director of instructional programs for the Gulfport School District where she helped lead the effort to implement the state's college and career readiness standards and develop the middle college concept and career academies at Gulfport High School. As part of the Innovative Schools program, this work helped lay the foundation for broader Carnegie unit offerings at middle school, flexible scheduling, and an expansion of dual-credit offerings. Dr. Evers also served as an elementary principal while in Gulfport as well as during her nine-year tenure with the Natchez-Adams School District. During her 27 years as an educator, she earned several honors, including teacher and administrator of the year. She has also served on several community boards and belonged to service organizations, including the Lynn Meadows Discovery Center Board of Trustees, Head Start Policy Board, executive committee of the Mississippi Gulf Coast Alumnae Chapter of Delta Sigma Theta Sorority, and Rotary Education Committee.

## June 13 | Plenary Session

### RTI EDUCATION SERVICES STAFF

#### Michael Martin *Education Consultant*



**Mike Martin** is an educational consultant at RTI International whose expertise includes K-12 education policy and instruction. Prior to joining RTI, Martin worked as the associate director of program and policy at the Hunt Institute where he wrote for policymakers and practitioners and supported states in raising standards and designing assessment and accountability systems. Martin spent six years in the policy and planning division in the North Carolina Department of Public Instruction where he worked closely with the academic services and communications departments to implement large-scale educational improvements across the state. Martin spent the first five years of his career teaching high school mathematics before transitioning into teacher coaching, educational leadership, and curriculum design. His professional interests include teacher and leader effectiveness, instructional design, policy implementation, and communication across educational sectors. Martin has worked extensively in rural and urban school settings and has written for and presented to state and national audiences on a variety of educational policy issues.

#### Laurie Baker *Education Consultant*



**Laurie Baker** is an educational consultant with national experience in the areas of innovative school design and educational leadership. Her research interests and areas of expertise include issues pertaining to poverty, race, and rurality. Baker has substantial experience as a practitioner, having served as a high school English teacher, middle school assistant principal, high school assistant principal for at-risk students, and early college high school principal. Dr. Baker's published research includes a quantitative study of the relationship between local fiscal capacity and student achievement in public schools. She has led an array of large-scale educational reform projects in Illinois, Indiana, Mississippi, North Carolina, and South Carolina. She is also a court-appointed guardian ad litem, an advocate for abused and neglected children. Throughout her career and volunteerism, Dr. Baker has sought to understand and combat the effects of poverty on our children and our communities.

June 13 | Plenary Session

## RTI EDUCATION SERVICES STAFF

**Marcia Edge Navarro**

*Education Consultant*



**Marcia Navarro** comes to the Center for Education Services with a wealth of educational leadership experience including her time as a district and school transformation leader at the North Carolina Department of Public Instruction where she led a team of transformation coaches who provided school and district leadership coaching throughout the state. Additionally, Marcia was senior managing director of teaching and learning at Teach for America-Eastern North Carolina and has held several school leadership positions including, most recently, the principalship of the Middle College High School at Durham Technical Community College. She started her career as a high school biology teacher. Marcia leads consulting projects and leverages her expertise in school and district

leadership to support our clients.

**Fredrica Nash**

*Education Consultant*



**Fredrica Nash** began her path toward education when selected to participate in the prestigious North Carolina Teaching Fellows program. She spent the early years of her career teaching science in Durham Public Schools and facilitating professional learning experiences for teachers on project-based learning for the New Tech Network. Nash's specialty is education coaching, and she is the chief architect of the coach development program and social-emotional learning services offered by RTI. She has designed and delivered presentations at state and national conferences on project-based learning, instructional coaching, instructional best practices, equity, and academic, social and emotional learning. Prior to joining RTI, Nash served as an instructional coach, curriculum writer, vice president of a nonprofit community outreach program, and director of coaching services. She has coached both new, veteran, and alternative-entry teachers throughout her educational career, focusing on the development of instructional capacity. Her research interests include teacher agency and learning through professional learning, teacher effect on marginalized student learning with attention to equity and social justice, and program evaluation using a multi-method approach.

leadership to support our clients.



# AGENDA

Wednesday, June 12, 2019

|                               |  |                     |
|-------------------------------|--|---------------------|
| <b>8:00 a.m. - 8:30 a.m.</b>  | <b>Registration</b>  |                     |
| <b>8:30 a.m. - 8:55 a.m.</b>  | <b>Welcome (Overview)</b><br><i>Dr. Sonja Robertson</i>  | <b>Exhibit Hall</b> |
| <b>9:00 a.m. - 10:20 a.m.</b> | <b>Concurrent Sessions</b>   |                     |
|                               | <b>Planning, Implementing, and Measuring Impact: It's the Standard</b><br><i>Dr. Sebrina Palmer</i><br>As lifelong learners, it is imperative that we seek opportunities to strengthen and continuously develop our professional craft. This session is designed to support school and district leaders in the development of professional learning systems that are aligned with the Learning Forward Standards for Professional Learning. The presenter will address correlating professional learning programs to the learning standards. Participants will also explore methods for measuring the impact of professional learning.   | <b>2A</b>           |
|                               | <b>Anchoring Success Through Equity Leadership</b><br><i>Dr. Erick Witherspoon</i><br>This presentation will illuminate leaders' abilities to connect, prioritize, and respond to all students' diverse cultural-learning needs. An engaging and electrifying experience awaits you as Dr. Witherspoon, a nationally recognized and awarded equity leader, delivers a prolific message that shouldn't be missed. To close the achievement gap, we must first close the relationship gap!<br>During this presentation, leaders and leadership teams will be empowered to galvanize relationships with diverse students, educational stakeholders, and the entire educational community. This experience will provide synergy to articulate your equity vision, define your equity leadership story, crystallize your equity values, and create tenets of your equity action plan. | <b>2B</b>           |
|                               | <b>Patriot Hour: How to Make Lunch Work for Everyone</b><br><i>Mr. Chris Fleming</i><br>Lewisburg High School uses Patriot Hour to address the many needs of today's high school students. Come see how we leverage our lunch hour to meet academic, extracurricular, and social concerns of our student population. We will share ideas you can use to steal time in a busy day to improve your school.   | <b>2C</b>           |
|                               | <b>Ensuring Cultural and Linguistic Responsiveness Using the Mississippi Professional Growth System</b><br><i>Mr. Phelton Moss</i><br>The session will engage participants in a deep dive of how to utilize the Mississippi Professional Growth System's growth rubric to increase teacher and leader effectiveness to become culturally and linguistically responsive to the diverse needs of students.   | <b>3D</b>           |
|                               | <b>Follow Me: Using Data PLCs</b><br><i>Mr. Fredrick Robinson</i><br>This session will highlight Quitman County Elementary School's use of data professional learning communities to move from low performing to high performing in a year. Participants will be provided with strategies to engage in meaningful discussions on data within the professional learning community that will have an impact on student achievement.  | <b>3C</b>           |
|                               | <b>Trauma and Its Impact</b><br><i>Dr. Talya Straughter</i><br>This presentation will give a general overview of trauma so educators can understand trauma in a broad and inclusive way, including its definition and various types. Participants will learn how the brain and body respond to stress and trauma. With that understanding, participants will also recognize the effects of trauma on students, staff, and schools. Participants will be able to apply knowledge of trauma to their daily work through discussion and activities.   | <b>3B</b>           |

# AGENDA

## Wednesday, June 12, 2019

|                         |   |                     |
|-------------------------|---|---------------------|
| 10:30 a.m. - 10:45 a.m. | <b>Break</b>  |                     |
| 10:45 a.m. - 12:00 p.m. | <b>Plenary Session</b>  |                     |
|                         | <p><b>Leadership Matters: Shifting Mindsets to Transform Schools</b></p> <p><i>Dr. Carla J. Evers</i></p> <p>How can we transform schools for our learners? The Mississippi College and Career Readiness Standards challenge our collective mindset about what students can accomplish when we empower them to greatness. This session will explore the sense of urgency and mindset changes required to swing the pendulum to transform schools.</p>   | <b>Exhibit Hall</b> |
| 12:00 p.m. - 1:30 p.m.  | <b>LUNCH (on your own)</b>  |                     |
| 1:30 p.m. - 2:50 p.m.   | <b>Concurrent Sessions</b>  |                     |
|                         | <p><b>The Access for All Guide</b></p> <p><i>Dr. Margaret Ellmer and Ms. Sharon Coon</i></p> <p><i>The Access for All Guide</i> was developed by the Mississippi Department of Education in collaboration with educators from across the state. This document provides teachers and administrators with guidance on strategies and support for struggling learners based on deficits exhibited by the learner. Attendees will receive a copy of the guide and learn how to use the valuable resource.</p>   | <b>2B</b>           |
|                         | <p><b>Trauma and Its Impact</b></p> <p><i>Dr. Talya Straughter</i></p> <p>This presentation will give a general overview of trauma so educators can understand trauma in a broad and inclusive way, including its definition and various types. Participants will learn how the brain and body respond to stress and trauma. With that understanding, participants will also recognize the effects of trauma on students, staff, and schools. Participants will be able to apply knowledge of trauma to their daily work through discussion and activities.</p>   | <b>3B</b>           |
|                         | <p><b>Learning Walks</b></p> <p><i>Ms. Christie Hatten</i></p> <p>This presentation will help participants know what to look for in their schools when conducting learning walks.</p>   | <b>2C</b>           |
|                         | <p><b>Chronic Absenteeism: Understanding the Impact of Student Absences</b></p> <p><i>Ms. Toni Kersh</i></p> <p>Participants will be able to define chronic absenteeism, understand its impact on positive student outcomes, and utilize strategies to reduce the chronic absenteeism.</p>  | <b>3C</b>           |
|                         | <p><b>High-Quality Instructional Materials: How to Evaluate and Select Quality Math Material</b></p> <p><i>Dr. Tenette Smith and Dr. Marla Davis</i></p> <p>In this interactive session, participants will review the Mississippi High-Quality Instructional Mathematics Material Review Rubric (HQIM2R2). Participants will also explore the process for identifying and selecting additional high-quality instructional material (HQIM) for use in Mississippi classrooms.</p>  | <b>3D</b>           |
|                         | <p><b>Planning, Implementing, and Measuring Impact: It's the Standard</b></p> <p><i>Dr. Sebrina Palmer</i></p> <p>As lifelong learners, it is imperative that we seek opportunities to strengthen and continuously develop our professional craft. This session is designed to support school and district leaders in the development of professional learning systems that are aligned with the Learning Forward Standards for Professional Learning. The presenter will address correlating professional learning programs to the learning standards. Participants will also explore methods for measuring the impact of professional learning.</p> | <b>2A</b>           |
| 3:00 p.m. - 4:00 p.m.   | <b>School Team Time</b>   | <b>Exhibit Hall</b> |
| 4:00 p.m. - 4:15 p.m.   | <b>Adjourn</b>  |                     |



# AGENDA

## Thursday, June 13, 2019

|                                |  |                     |
|--------------------------------|--|---------------------|
| <b>7:30 a.m. - 8:00 a.m.</b>   | <b>Sign In</b>   |                     |
| <b>8:00 a.m. - 8:15 a.m.</b>   | <b>Welcome</b><br><i>Dr. Sonja Robertson</i>   | <b>Exhibit Hall</b> |
| <b>8:15 a.m. - 9:30 a.m.</b>   | <b>Plenary Session</b>   |                     |
|                                | <p><b>Communicating Change</b><br/> <i>Mr. Mike Martin, Dr. Laurie Baker, Ms. Fredrica Nash, and Ms. Marcia Navarro</i></p> <p>Objectives of this session include connecting the work in the school to the underlying “why” of this work: student outcomes; developing insights into leading change from the perspective of the leader and those you will lead; and designing a concrete plan to communicate change throughout the school using a storyboarding process.</p>             | <b>Exhibit Hall</b> |
| <b>9:40 a.m. - 10:25 a.m.</b>  | <p><b>Transformation Academy Panel</b><br/>           2018-2019 Transformation Academy participants will engage in a panel conversation on the four Early Actions for jump-starting instructional transformation and how their engagement informs their practice.</p>  | <b>Exhibit Hall</b> |
| <b>10:30 a.m. - 11:50 a.m.</b> | <b>Concurrent Sessions</b>   |                     |
|                                | <p><b>Responding to Detractors</b><br/> <i>Mr. Mike Martin and Dr. Laurie Baker</i></p> <p>This session is designed to help principals guide transformational change within their building by preparing responses to detractors and skeptical staff. Objectives include reflecting on the motivations, dispositions, and characteristics of the adults you will lead and preparing to gain the buy-in and investment of your staff.</p>  | <b>2B</b>           |
|                                | <p><b>Chronic Absenteeism: Understanding the Impact of Student Absences</b><br/> <i>Ms. Toni Kersh</i></p> <p>Participants will be able to define chronic absenteeism, understand its impact on positive student outcomes, and utilize strategies to reduce the chronic absenteeism.</p>   | <b>3C</b>           |
|                                | <p><b>Utilizing a Theory of Action for Continuous School Improvement</b><br/> <i>Dr. Robyn Madison-Harris</i></p> <p>This session will demonstrate how to develop and use a theory of action to drive continuous school improvement. It will examine the Mississippi Department of Education Office of School Improvement theory of action and offer participants the opportunity to draft and refine theories of action.</p>  | <b>2A</b>           |
|                                | <p><b>Leveraging and Aligning Funds</b><br/> <i>Mr. Quentin Ransburg</i></p> <p>The alignment of plans, such as the Title I Schoolwide Plan and Comprehensive School Improvement Plan, is an important factor in maximizing impact of resources. This session will provide members of school leadership teams with guidance and best practices for leveraging funding sources.</p>   | <b>3D</b>           |
|                                | <p><b>Monitoring the Effectiveness of Evidence-Based Interventions</b><br/> <i>Dr. Ursula Hill</i></p> <p>This session will share techniques for monitoring the fidelity and progress of implementation for evidence-based initiatives and making data-driven decisions.</p>   | <b>2C</b>           |
|                                | <p><b>Improving Literacy Instruction: Scheduling With the Student in Mind</b><br/> <i>Ms. Kristen Wells</i></p> <p>This session presents recommendations to assist educators with improving literacy instruction among elementary, upper elementary, and middle school students. During this session, we will discuss evidence-based reading instruction, examine specific recommendations to improve literacy skills, and explore resources and suggested scheduling opportunities.</p> | <b>3B</b>           |
| <b>11:50 a.m. - 12:40 p.m.</b> | <b>School Team Time</b>  | <b>Exhibit Hall</b> |
| <b>12:45 p.m. - 1:00 p.m.</b>  | <b>Adjourn</b>   |                     |



## First Floor

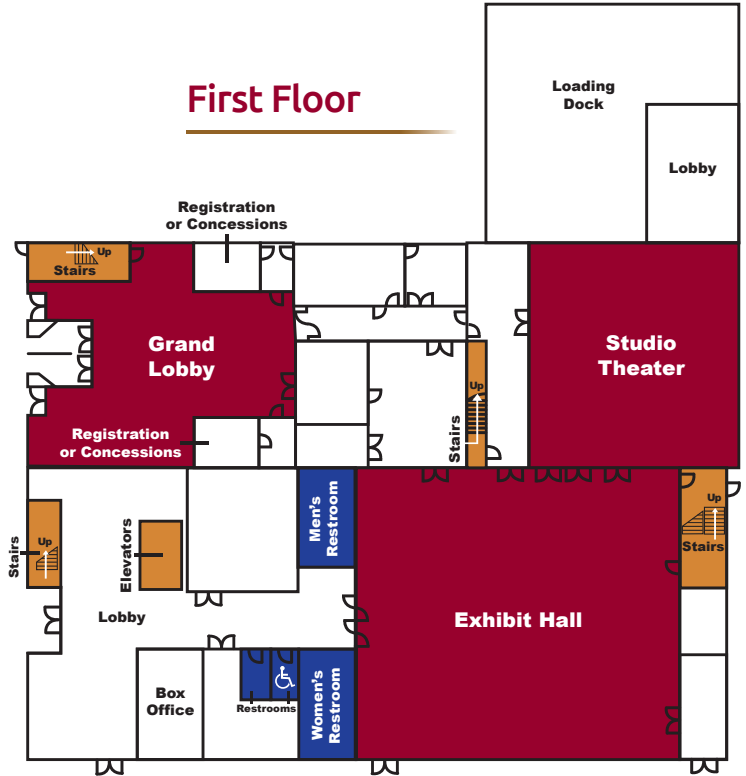

## Second Floor

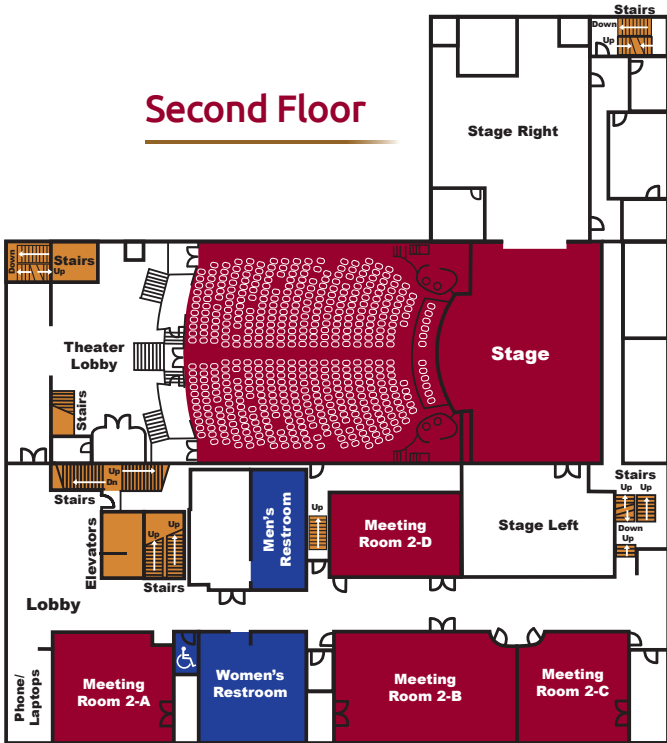

## Third Floor

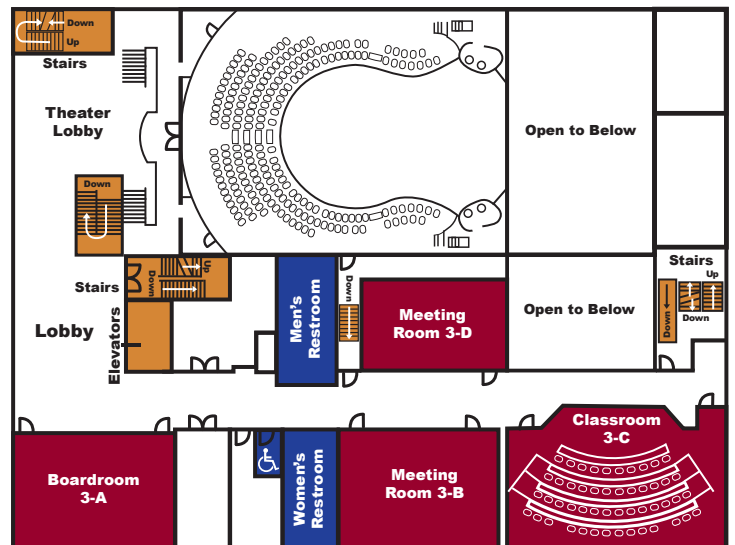



## Office of School Improvement Staff

Dr. Sonja J. Robertson  
Executive Director of School Improvement  
srobertson@mdek12.org

Ms. Joyce Jones  
Fiscal Office Manager  
jojones@mdek12.org

Ms. Re'Nona Jackson  
Programmatic Office Manager  
rjackson@mdek12.org

Ms. Shakinna Patterson, Ed.S.  
Director of School Improvement Programs  
spatterson@mdek12.org

Dr. BoNita L. Harris  
Director of Program Monitoring and Support  
bonitaharris@mdek12.org

Mr. Deowarski McDonald  
Coordinator of School Improvement Programs  
dmcdonald@mdek12.org

Ms. Alfie Clark, Ed.S.  
Coordinator of School Improvement Programs  
alclark@mdek12.org

### Lead School Improvement Coaches

Dr. Lekeisha Sutton  
lsutton@mdek12.org

Ms. Jeanne Park  
jeanne.park@mdek12.org

Dr. Lea Johnson  
lea.johnson@mdek12.org

Mr. Jerry Moore  
jerry.moore@mdek12.org

### Office of School Improvement

MS Department of Education  
P. O. Box 771  
Jackson, MS 39205-0771  
Phone: 601-359-1003